

# Technical Proposal for JXWG28200W3A6 Waveguide Multiplexer

## Revision History

| Version | Date       | Author | Revision description         | Comment |
|---------|------------|--------|------------------------------|---------|
| V1.0    | 2017/05/17 | Lee    | Created                      | /       |
| V2.0    | 2017/07/21 | Lee    | Update the Mechanical layout | /       |
| V2.1    | 2017/07/31 | Lee    | Change the Surface treatment | /       |
|         |            |        |                              |         |
|         |            |        |                              |         |
|         |            |        |                              |         |

**JING XIN MICROWAVE TECHNOLOGY CO.,LTD**

E-mail: [sales@cdjx-mw.com](mailto:sales@cdjx-mw.com) Web: <http://www.cdjx-mw.com>

TEL: +86-28-85026087 FAX: +86-28-65941390 Zip Code:610045

Add: No.65,West 1st Wu Ke Road, Wu Hou District, Cheng Du City, Si Chuan Province, China.

## Table of content

|  |   |
|--|---|
| Technical Proposal for JXWG28200W3A6 Waveguide Multiplexer ..... | 1 |
| 1. Mechanical layout.....  | 3 |
| 2. Electrical analysis .....                                     | 4 |
| 2.1 Electrical specifications .....                              | 4 |
| 2.2 The simulation curve .....                                   | 4 |

## Figures

|  |   |
|--|---|
| Figure 1 JXWG28200W3A6 front panel layout.....     | 3 |
| Figure 2 The simulation curve of Multiplexer ..... | 4 |

## Tables

|   |   |
|---|---|
| Table 1 Mechanical Specifications .....                   | 3 |
| Table 2 Electrical specifications @ Tx1/Tx2/Rx path ..... | 4 |

**JING XIN MICROWAVE TECHNOLOGY CO.,LTD**

E-mail: [sales@cdjx-mw.com](mailto:sales@cdjx-mw.com) Web: <http://www.cdjx-mw.com>

TEL: +86-28-85026087 FAX: +86-28-65941390 Zip Code:610045

Add: No.65,West 1st Wu Ke Road, Wu Hou District, Cheng Du City, Si Chuan Province, China.

## 1. Mechanical layout

Table 1 Mechanical Specifications

|                 |                               |
|-----------------|-------------------------------|
| Dimension       | LxWxH: 192mm x 125mm x 30.1mm |
| Port connectors | WR51 (EIA)                    |
| Finish          | Silver plated                 |
| Notes           | Material shall be RoHS 6/6    |

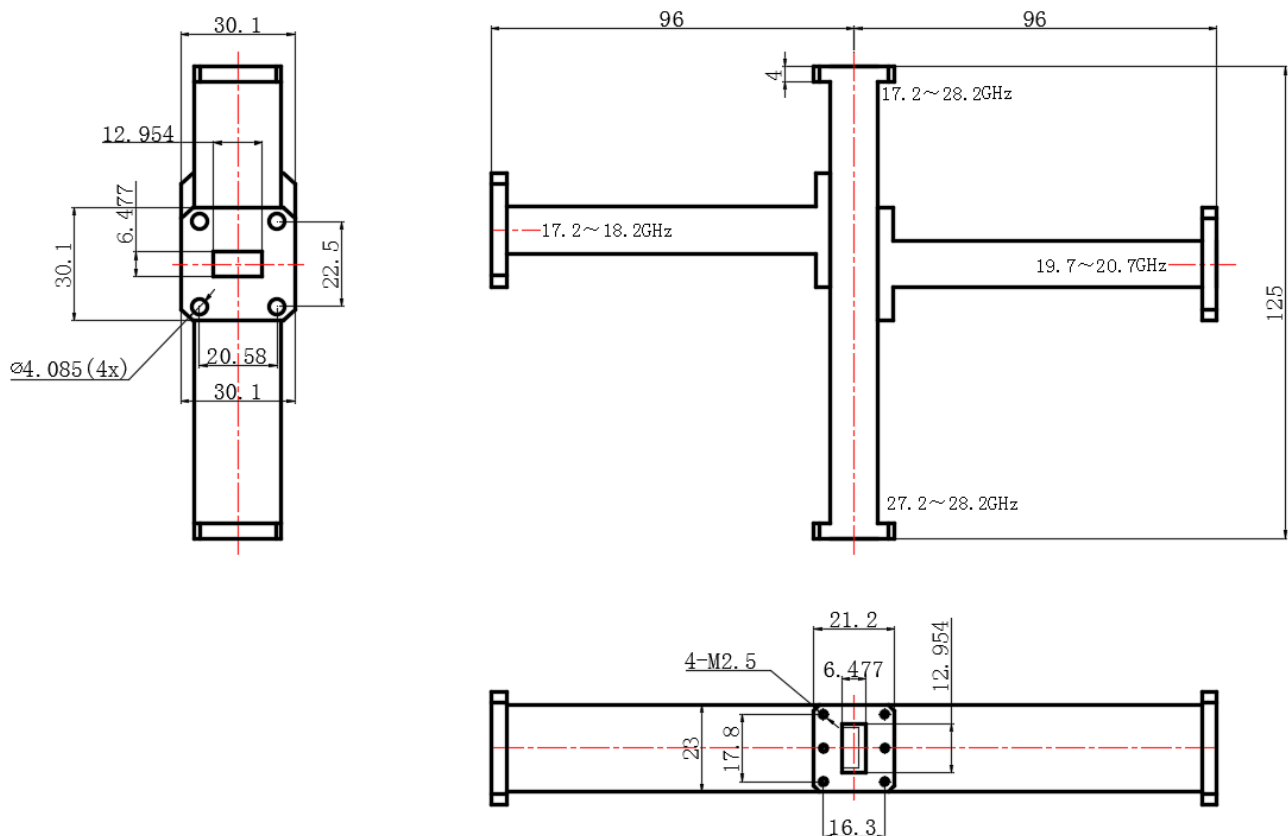

Figure 1 JXWG28200W3A6 front panel layout

**JING XIN MICROWAVE TECHNOLOGY CO.,LTD**

E-mail: [sales@cdjx-mw.com](mailto:sales@cdjx-mw.com) Web: <http://www.cdjx-mw.com>

TEL: +86-28-85026087 FAX: +86-28-65941390 Zip Code:610045

Add: No.65,West 1st Wu Ke Road, Wu Hou District, Cheng Du City, Si Chuan Province, China.

## 2. Electrical analysis

### 2.1 Electrical specifications

Table 2 Electrical specifications @ Tx1/Tx2/Rx path

| Item | Parameter      | 17.2-18.2GHz(Tx1)     | 19.7-20.7GHz(Tx2) | 27.2-28.2GHz(Rx)     |
|------|----------------|-----------------------|-------------------|----------------------|
| 1    | VSWR           | 1.3                   |                   |                      |
| 2    | Insertion loss | ≤1.3 dB               |                   |                      |
| 3    | Isolation      | ≥30dB@Tx1-Tx2&Tx2-Tx1 |                   | ≥100dB@Tx1-Rx&Tx2-Rx |

### 2.2 The simulation curve

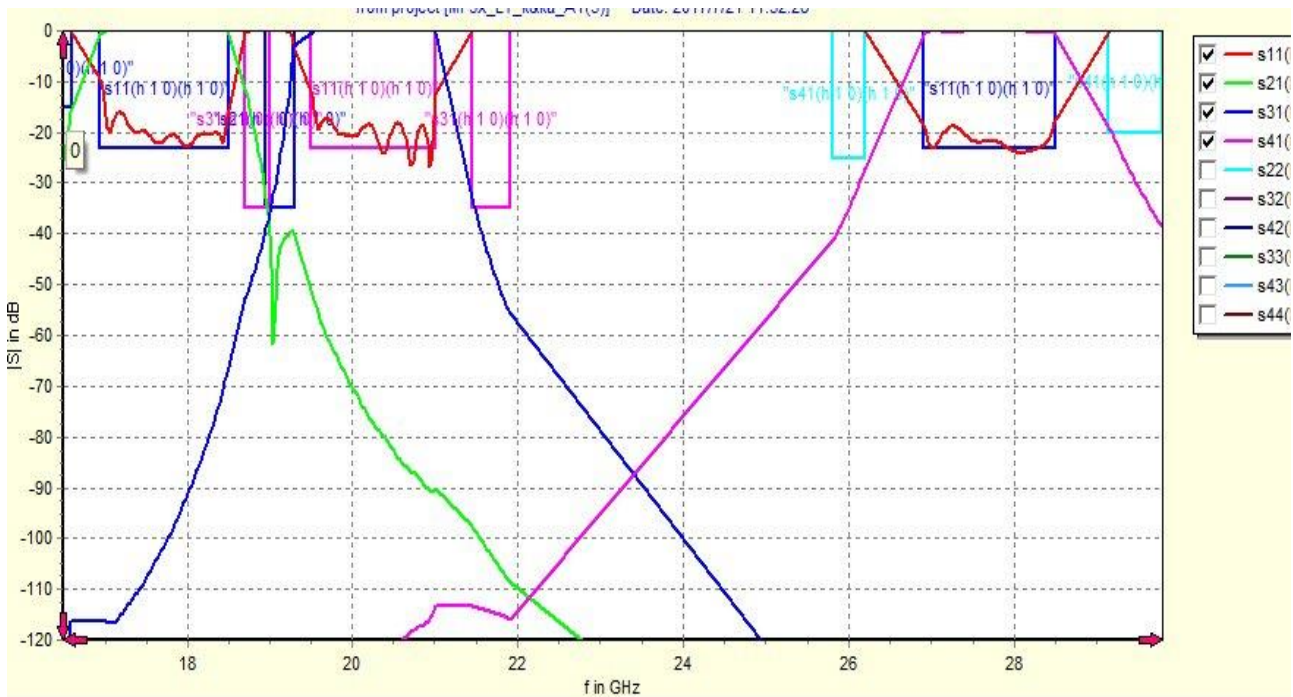

Figure 2 The simulation curve of Multiplexer

**JING XIN MICROWAVE TECHNOLOGY CO.,LTD**

E-mail: [sales@cdjx-mw.com](mailto:sales@cdjx-mw.com) Web: <http://www.cdjx-mw.com>

TEL: +86-28-85026087 FAX: +86-28-65941390 Zip Code:610045

Add: No.65,West 1st Wu Ke Road, Wu Hou District, Cheng Du City, Si Chuan Province, China.